

REVISION DATE / DESCRIPTION

- REVISION 'A' - 27.01.17
 - BIN STORE MARGINALLY REVISED
 - PASSING FOOTPATH WIDTH REVISED
 - LANDSCAPING REVISED ACCORDINGLY
- REVISION 'B' - 12.05.17
 - GENERAL CLIENT UPDATE
- REVISION 'C' - 13.07.17
 - IN SITE TRAFFIC FLOW INDICATED
 - BIN TYPES ANNOTATED
 - NECESSARY VISIBILITY SPLAYS SHOWN
 - GATE/RAILINGS REVISED ACCORDINGLY
 - VISITOR BAYS ANNOTATED

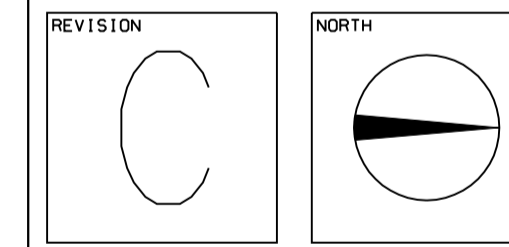
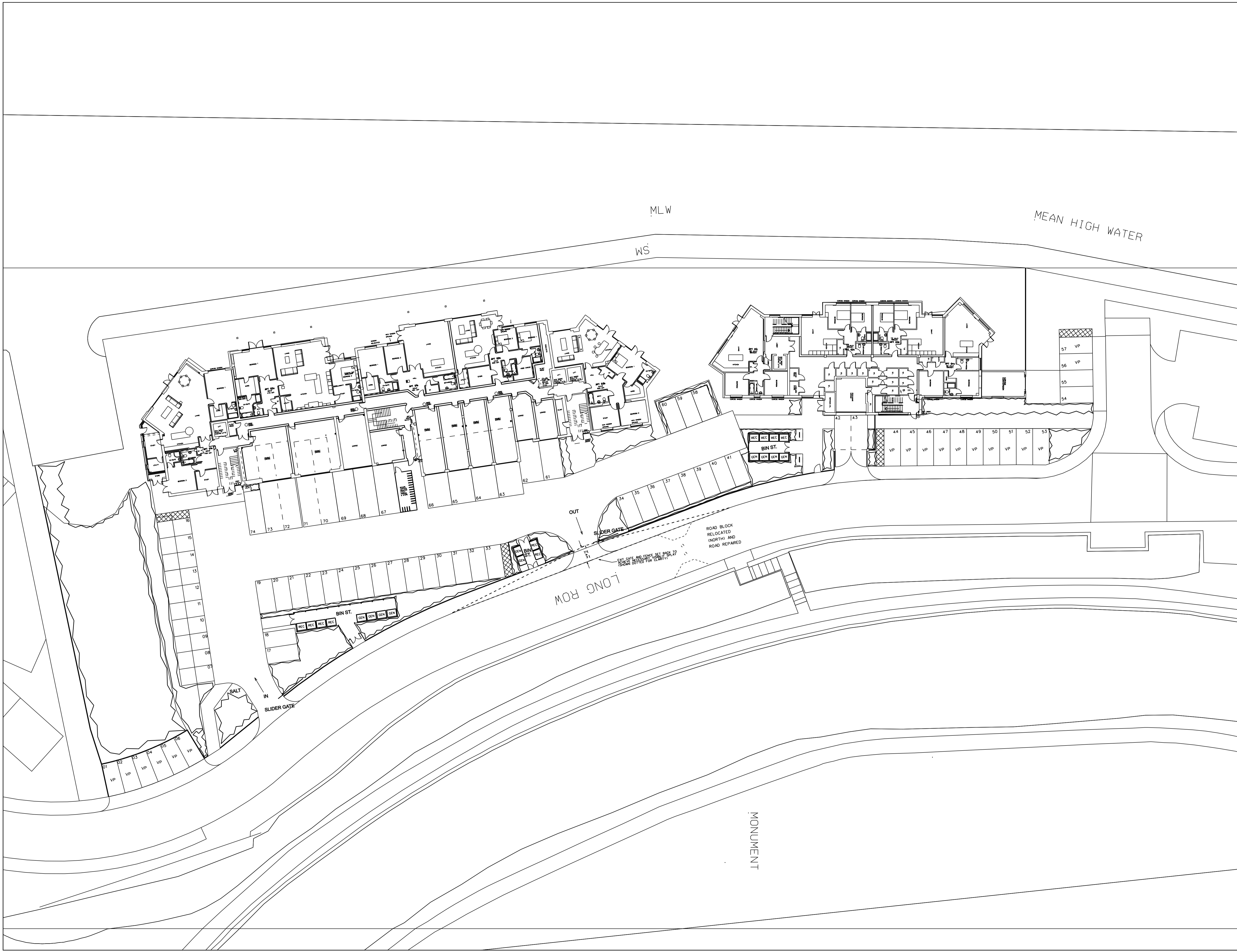

STAGE: PLANNING

PROJECT: PROPOSED EXTERNAL MODIFICATIONS FOR RESIDENTIAL PRIOR APPROVAL AT MARKET DOCK, LONG ROW, SOUTH SHIELDS, NE33 1JA

DRAWING: PROPOSED SITE PLAN

| | | |
|-------------|-------------|----------|
| PROJECT NO. | DRAWING NO. | REVISION |
| 2924 | C-14 | C |

| | | |
|---------|----------------------|----------|
| DATE | SCALE | DRAWN BY |
| JAN '17 | 1:250@A1 1:500@A3 | MM |

MARIO MINICHELLA ARCHITECTS

UNIT 4, WITNEY WAY,
HI-TECH VILLAGE,
SOLDON BUSINESS PARK
TYNE AND WEAR
NE25 9PE
T: 0191 3002227
W: WWW.M.M.A.NET
E: INFO@M.M.A.NET

THIS DRAWING IS COPYRIGHT OF M.J.M. LIMITED
NOT TO BE SCALED ALL DIMENSIONS TO BE CHECKED ON SITE